

Pos. Nr. Pos.no.	Beschreibung Description	Art.-Nr. Art.no.	Preisgruppe Price bracket
<b>7560021</b> DB/HECTORRAIL BR162 = N			
<b>7570021</b> =  N			
1	GEHÄUSE KPL. BETR. NR. 162.007 Body ass. complete loco. no. 162.007	107560021	38
2	FLUTLICHTLEITER Light conductor	13738004	11
3	Lichtleiter Light conductor	137560021	5
4	DACHTRAVERSE FÜR EINHOLMSTROM. Roof traverse for single arm pantograph	00177346	5
5	PRESSLUFTSCHALTER Air pressure switch	144016	3
6	SIGNALHORN Signal horn	144017	4
7	ANTENNE Antenna	00197807	2
8	ROHR Brass tube	00567770	2
9	LICHTPLATINE KPL. Light PCB,complete	65716500	14
10	SCHALTPLATINE kpl. Switch plate complete	65716600	28
11	BRÜCKENSTECKER Jumper	00664005	13
12	EINHOLMSTROMABNEHMER Single arm pantograph	00677018	20
13	SCHRAUBE Screw	00700303	1
14	SENKSCHRAUBE Countersunk screw	00702303	1
15	PUFFER Buffer	00757021	3
16	ISOLATOREN,SCHALTER-SATZ Isolators,switch - set	14738009	12
17	ISOLATOR + SCHALTFEDER Isolator + switch spring	64734602	8
<b>Sound</b>			
18	LAUTSPRECHER Loudspeaker	68701100	16
19	LAUTSPRECHERAUFNAHME Loudspeaker reception	68701300	16
20	SOUNDDECODER Sound decoder	68738072	41

Änderungen in Konstruktion und Ausführung vorbehalten  
We reserve the right to change the construction and specification

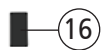
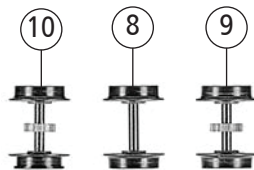
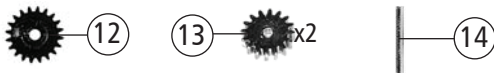
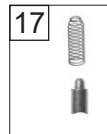
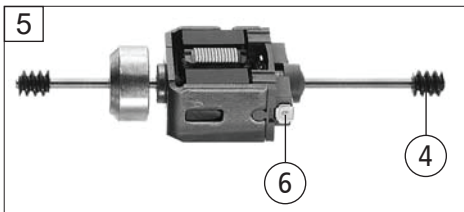
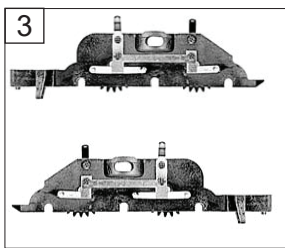
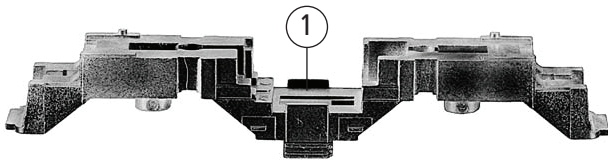

Pos. Nr. Pos.no.	Beschreibung Description	Art.-Nr. Art.no.	Preisgruppe Price bracket
7560021	DB/HECTORRAIL BR162	=	N
7570021		=	N
1	GRUNDRAHMEN Base frame	40738009	19
2	DREHGESTELLRAHMEN Bogie framework	00417383	11
3	DREHGESTELLBLOCK KPL. Bogie block, complete	457560021	15
4	SCHNECKE D = 4MM L = 7MM Worm gear	00567605	6
5	MOT.M.SCHW.O.MASSEKONTAKT Motor with flywheel w/o ground cont.	05073821	30
6	KOHLHALTER Brush holder	00507801	1
7	ACHSE Z.DG-BEFESTIGUNG Bogie fixation pin	00527002	2
8	RADSATZ KPL. OHNE ZAHNRAD Wheelset complete, w/o gear wheel	00537038	12
9	RADSATZ KPL. MIT ZAHNRAD Wheelset complete, with gear wheel	00537039	13
10	RADSATZ KPL.(M.ZAHNRAD) Wheelset complete (with gear wheel)	00537049	13
11	HAFTREIFEN Traction tyre	00547002	1
12	ZAHNRAD Z=20 Gear wheel	00567101	3
13	ZAHNRAD Z=24 Gear wheel	00567131	2
14	ACHSE D1,5 L=5.7 Axle	144459	6
15	KONTAKTBUEGEL F.DREHGEST. Contact plate for bogie	00657004	13
16	BLATTRICHTFEDER F.KUPPLUNG Flat straightening spring for coupling	00767006	1
17	ERSATZ-SCHLEIFKOHLEN Carbon brushes set	133936	5
18	KUPPLUNGSHAKEN Coupling hook	146925	3